

REVISIONS		
REV. NO.	DESCRIPTION	DATE

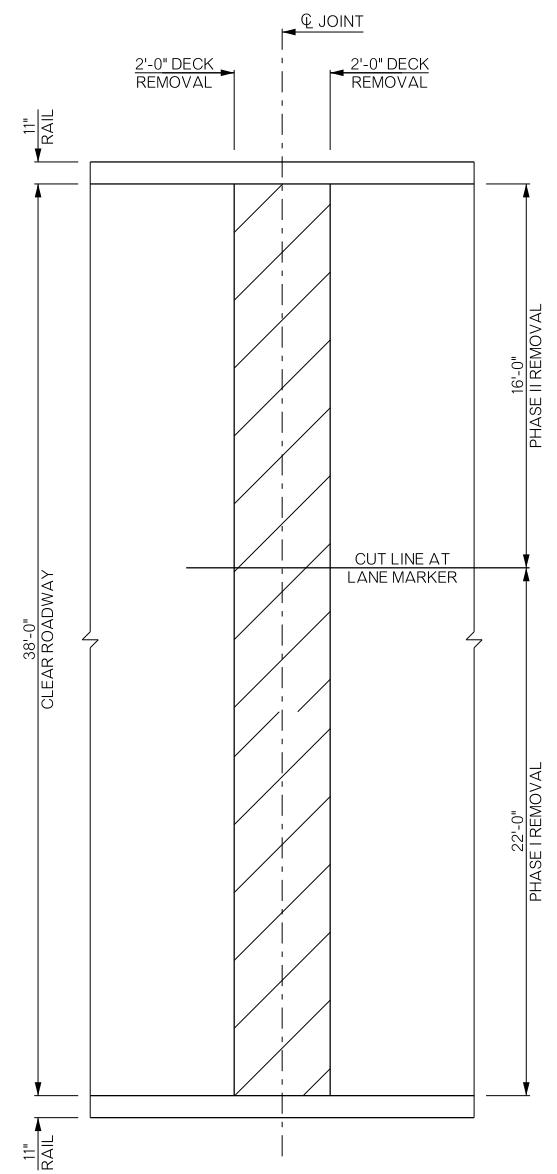

**DETAIL OF DECK REMOVAL AT CONSTRUCTION JOINT**

THE CONTRACTOR SHALL AVOID CUTTING INTO STRUCTURAL STEEL BENEATH BRIDGE DECK DURING SAWING.

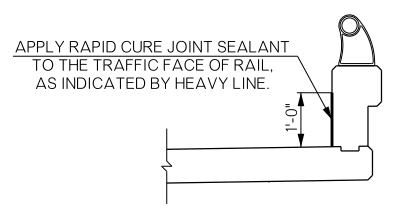

**REHABILITATED CONSTRUCTION JOINT AT TRAFFIC RAIL**

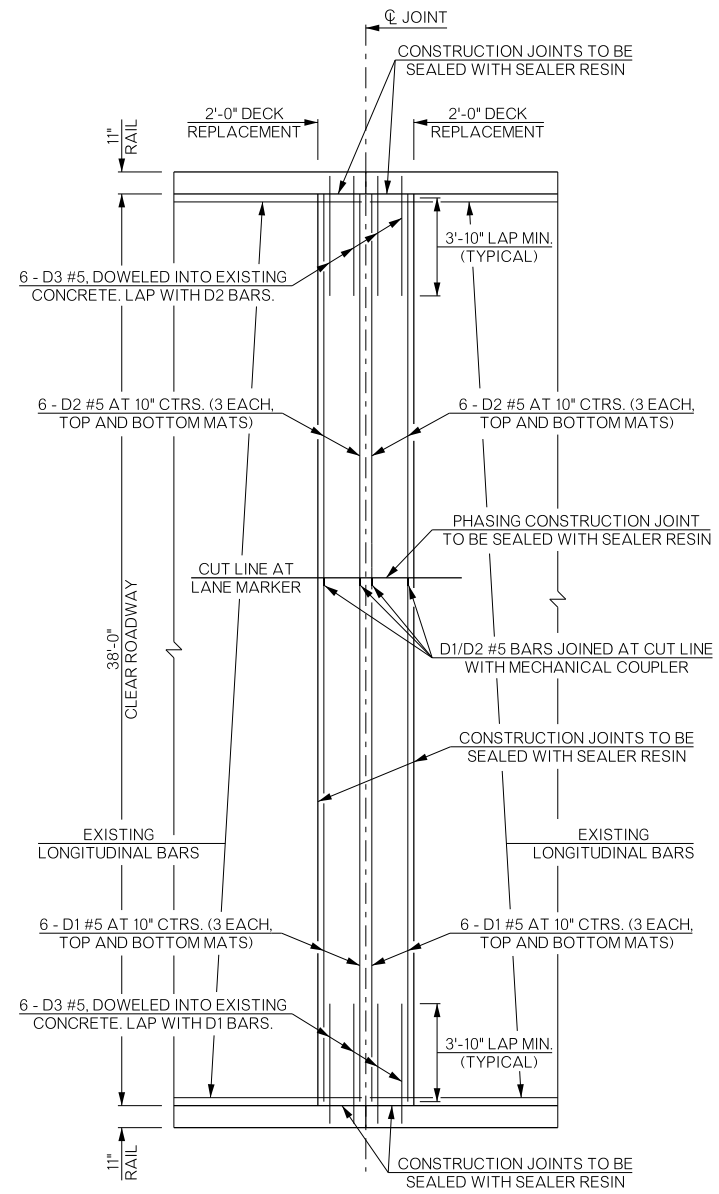

**DETAIL OF DECK REPAIR AT CONSTRUCTION JOINT**

NOTE: D4 AND D5 BARS NOT SHOWN FOR CLARITY.

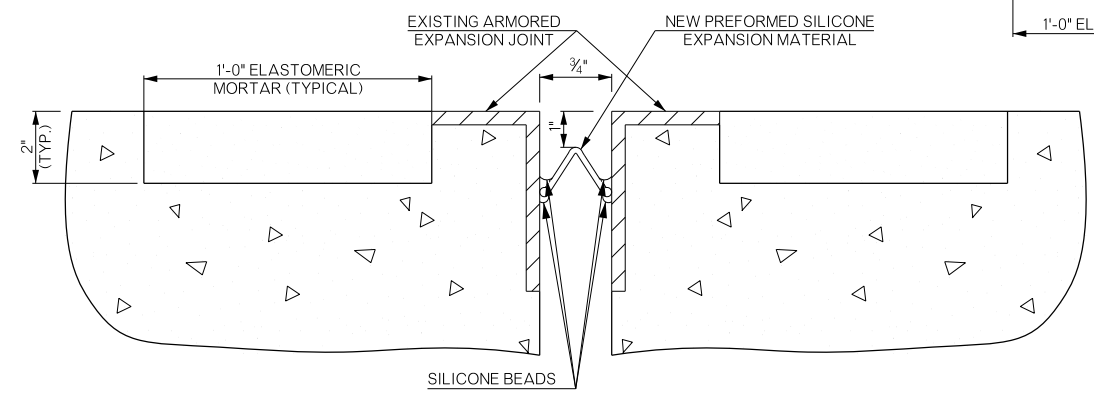

**REHABILITATED EXPANSION JOINT AT ABUTMENT NO. 2**

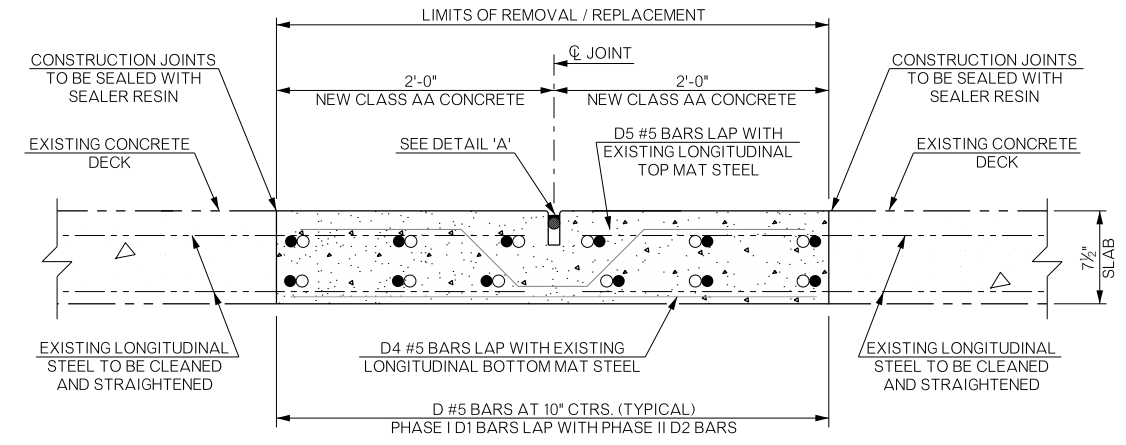

**TYPICAL SECTION OF REHABILITATED CONSTRUCTION JOINT**

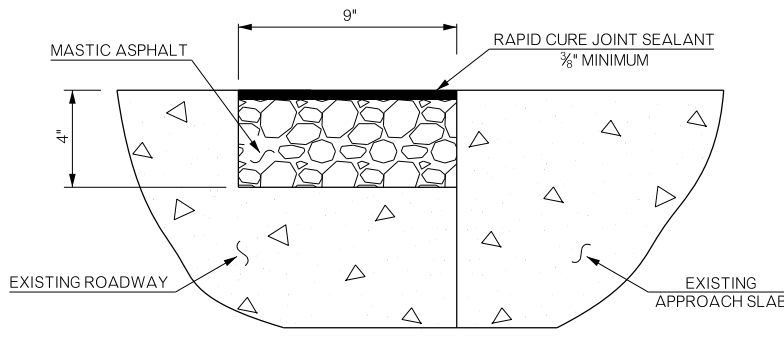

**REHABILITATED RELIEF JOINTS AT APPROACH SLABS**

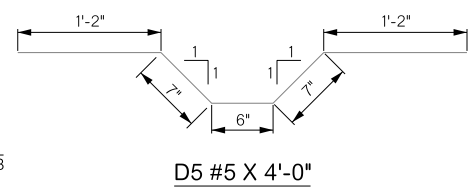

**D5 #5 X 4'-0"**

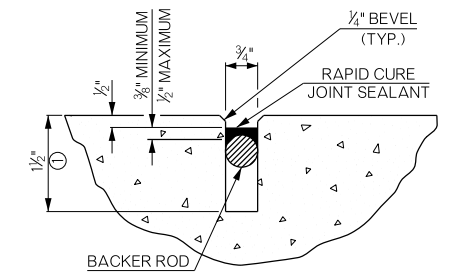

**DETAIL 'A'**

① SAW TO THE DEPTH SHOWN TO PROVIDE CLEAN, STRAIGHT SURFACES.

**BAR LIST ONE JOINT REPAIR (PHASE I) (9 REQUIRED FOR BRIDGE)**

MARK	NO.	SIZE	FORM	LENGTH
EPOXY COATED				
D1	12	#5	STR.	21'-10"
D3	12	#5	STR.	5'-0"
D4	34	#5	STR.	3'-8"
D5	13	#5	BNT.	4'-0"

**BAR LIST ONE JOINT REPAIR (PHASE II) (9 REQUIRED FOR BRIDGE)**

MARK	NO.	SIZE	FORM	LENGTH
EPOXY COATED				
D2	12	#5	STR.	15'-10"
D3	12	#5	STR.	5'-0"
D4	26	#5	STR.	3'-8"
D5	9	#5	BNT.	4'-0"

② LENGTH OF ANCHORAGE SYSTEM TO BE DETERMINED BY MANUFACTURERS SPECIFICATIONS (SEE GENERAL NOTES)

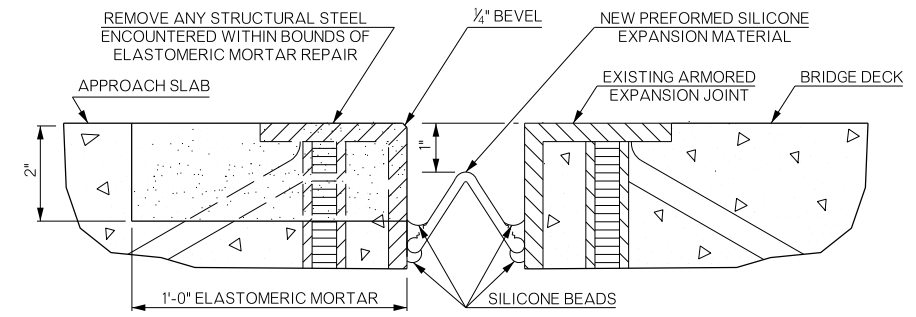

**REHABILITATED EXPANSION JOINT AT ABUTMENT NO. 1**

**QUANTITIES ONE CONSTRUCTION JOINT REPAIR (9 REQUIRED FOR BRIDGE)**

ITEM	UNIT	PHASE I	PHASE II	TOTAL
RAPID CURE JOINT SEALANT	L.F.	23.00	17.00	40.00
CLASS AA CONCRETE	C.Y.	2.10	1.50	3.60
EPOXY COATED REINFORCING STEEL	LB.	530.00	400.00	930.00
SEALER CRACK PREPARATION	L.F.	48.00	40.00	88.00
SEALER RESIN	GAL.	0.40	0.30	0.70
(SP) CORROSION INHIBITOR (SURFACE APPLIED)	S.Y.	4.00	3.00	7.00

BRIDGE "D" US-69 NORTHBOUND OVER W. ARKANSAS ST. & R.R. BRYAN COUNTY

**DETAILS OF JOINT REHABILITATION (BRIDGE "D")**

Design	N/A	N/A
Detail	DAN	5/16
Check	TEE	6/16
Squad	HENSLEY	
Engr.	DEFRANCO	

STATE OF OKLAHOMA DEPARTMENT OF TRANSPORTATION

JOB/PIECE NO. 24333(08) SHEET NO. B008